

P.NO.	PART NAME	MATERIAL	
		CAST STEEL	
1	BODY	ASTM A-216 Gr. WCB	
2	BONNET	ASTM A - 216 Gr. WCB	
3	WEDGE	A 216 WCB with 13% Cr. STEEL FACING	
4	BONNET GASKET	SS 304 SPIRAL WOUND GASKET WITH GRAPHOL FILLER	
5	SEAT	A 105 + 13% Cr. FACING	
6	STUD / NUT	ASTM A 193 Gr. B7/A 194 Gr.2H	
7	BACK SEAT	AISI 410	
8	GLAND	AISI 410	
9	GLAND PACKING	GRAPHITED LUBRICATED NON-ASBESTOS IMPREGNATED WITH SACRIFICIAL INCONEL WIRE	
10	GLAND BOLTING	ASTM A 193 Gr. B7/A 194 Gr.2H	
11	GLAND FLANGE	CARBON STEEL	
12	STEM	AISI 410	
13	YOKE BOLTING	ASTM A 193 Gr. B7/A 194 Gr.2H	
14	GEAR BOX	HEAVY DUTY STANDARD MAKE	

**NOTE :-**

MATERIAL GIVEN IN TABLE IS FOR REFERENCE ONLY.  
OTHER MATERIALS LIKE CARBON STEEL, LOW CARBON STEEL, ALLOY STEEL, STAINLESS STEEL, DUPLEX STEEL, SUPER DUPLEX STEEL, ALLOY 20, MONEL, INCONEL, HASTELLOY, COPPER ALLOY AVAILABLE AS PER SERVICE REQUIREMENT.

Size(NB)	F to F	OD	FT	K' PCD	Hole X ØD	RF	H
300mm	356	485	31.75	431.8	12 X 25.4	381	1035
350mm	381	535	35.05	476.3	12 X 28.4	412.8	1275
400mm	406	595	36.5	539.8	16 X 28.4	469.9	1455
450mm	432	635	39.6	577.9	16 X 31.7	533.4	1609
500mm	457	700	42.9	635	20 X 31.7	584.2	1814
600mm	508	815	47.7	749.3	20 X 35	692.1	2175

ENGINEERING DATA

DESIGN CODE	API. 600 / ASME B 16.34
FACE TO FACE	ASME B 16.10
END CONNECTION	ASME B 16.5 RF TO 125-250 AARRH
INSPECTION & TESTING	API. 598

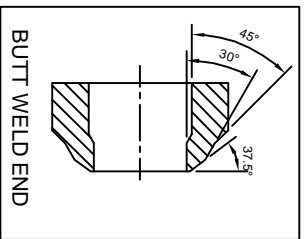

HYDRO TEST: 150#	SEAT	BACK SEAT	AIR TEST SEAT
BODY	22 KG/CM <sup>2</sup>	22 KG/CM <sup>2</sup>	07 KG/CM <sup>2</sup>
32 KG/CM <sup>2</sup>			



**NORFLOW CONTROLS**  
Industrial Valves

DRN.: B.M.P

CHK.: V.G.P

APRD.: S.K.P

DATE: 01.04.19

SCALE: NTS

**GATE VALVE FLANGED ENDS, 150#.**

DRG NO.: NC/GTV/150/300-600